

ASPEN SECURITY FORUM



Participant Logistics Memo

All times are listed in Mountain Time (MT).

Conference Location

Aspen Meadows Resort

845 Meadows Road, Aspen, CO 81611

<https://www.aspenmeadows.com>

Please note that there is no lodging available for attendees at the Aspen Meadows Resort during the Aspen Security Forum.

Registration Packet Pick-Up

Participant registration packets will be available for pick-up no earlier than 11:00 AM on Tuesday, July 15 in the Doerr-Hosier Building on the Aspen Meadows campus. Registration packets will be available for pick-up until the final day of the Forum, Friday, July 18.

In addition to a Forum badge, attendees will receive an official Aspen Security Forum agenda and an Aspen Security Forum bag. For security reasons, attendees must wear their badge at all times and badge sharing is strictly prohibited.

Event Information

ASF Agenda

The Forum will begin at approximately 5:00 PM on Tuesday, July 15. Programming will run from approximately 9:00 AM to 5:00 PM on Wednesday and Thursday, and from approximately 9:00 AM to 12:30 PM on Friday, July 18.

When the 2025 ASF agenda is released in July, the most up-to-date version will be available on our website [here](#). Upon arrival, you will receive a program book in your registration packet that will contain a QR code to the official agenda. **Please note that, given the nature of our speakers' and moderators' work and schedules, all panels are subject to change.**

Travel & Lodging

We encourage all participants to secure their flights and lodging as soon as possible once their pass is issued. For information on hotels in Aspen, please consult the [ASF Lodging Guide](#).

Getting Around Aspen During ASF

Convenient shuttles link the Aspen Security Forum to various hotels and locations in downtown Aspen. Shuttles will operate from Tuesday, July 15 – Friday, July 18 as outlined in the **transportation page in the program** and will make continuous loops between the event venue

and hotels in town. The wait for the shuttles can vary, usually up to 15 minutes. There is no parking available on campus for attendees, so we encourage the use of the Security Forum shuttle, public transportation, cycling, or walking. The Aspen Institute is a pleasant 20-minute walk from downtown Aspen.

Aspen Security Forum Shuttle

ASF will provide a complimentary shuttle service for the duration of the conference (July 15-18) on a continuous loop to the Aspen Institute campus at the times scheduled below.

- TUESDAY, JULY 15
Continuous Service: 12:00 PM - 9:30 PM
- WEDNESDAY, JULY 16
Opening Service: 7:00 AM - 9:30 AM
Closing Service: 4:30 PM - 7:00 PM
- THURSDAY, JULY 17
Opening Service: 7:00 AM - 9:30 AM
Closing Service: 4:30 PM - 7:00 PM
- FRIDAY, JULY 18
Opening Service: 7:00 AM - 9:30 AM
Closing Service: 11:30 AM - 1:30 PM

Cross-Town Shuttle

Every 30 minutes, the RFTA Cross-Town Shuttle provides free transportation to and from downtown Aspen to the Aspen Institute campus/Benedict Music Tent. The bus stop is located in the main Music Tent parking lot, which is a 10-minute walk to the venue. Call [+1 \(970\) 925-8484](tel:+19709258484) or visit their [website](#) for more information. The schedule is:

- Daily 7:45 AM – 10:45 PM
- Outbound from Rubey Park (downtown Aspen) to Harris Hall at the Aspen Institute campus at :06 and :36 past the hour.
- Inbound from Harris Hall at the Aspen Institute campus to Rubey Park at :15 and :45 past the hour.

Taxis and Ride Share Services

Individual car and ride share services in Aspen are extremely limited. If needed, Aspen High Mountain Taxi 24-hour service can be reached at [+1 \(970\) 925-8294](tel:+19709258294). We also encourage you to check out the [Downtowner](#) for on-demand rides.

WE-Cycle Stations

Enjoy the fresh mountain air and ride a bike or e-bike to and from the Security Forum. Stations are located throughout town, and there are two locations on or near the Aspen Meadows campus. Call [+1 \(970\) 205-9222](tel:+19702059222) or visit www.we-cycle.org for more information.

Private Cars

If you are interested in booking a private car in Aspen, we recommend [Aspen Transportation Co.](#)

Frequently Asked Questions

Registration and Ticketing

How and when can I register for the 2025 Aspen Security Forum?

Those interested in attending the 2025 Aspen Security Forum can apply to attend [here](#). We will consider each request carefully and make decisions on a rolling basis.

What is the cost of registration in 2025?

A participant pass costs \$4,000 and a patron pass costs \$12,000 (of which \$7,000 is tax-deductible). Once your pass is issued, your pass will guarantee you access to all programming, receptions, and events included in the official ASF agenda. Breakfasts and lunches on Wednesday, Thursday, and Friday will be provided during Forum programming. Passholders are also invited to join us for the opening reception with refreshments and light bites the evening of Tuesday, July 15.

Are there events at the Forum that are open to the public?

The opening session on Tuesday, July 15 and closing session on Friday, July 18 are open to ticketed members of the public. Please [subscribe to our newsletter](#) for updates on ticketed events as we near the opening session of ASF 2025.

Do you sell individual day passes?

No, the Aspen Security Forum does not offer individual day passes.

I'm interested in attending ASF as a member of the media. How do I apply for press credentials?

The Aspen Security Forum provides a limited number of press passes to qualified individuals who wish to attend the Forum as a member of the media. Members of the press can apply for credentials [here](#).

How can I register a staff member who will be accompanying me to the Forum? Will they be able to attend all events?

Staff members accompanying an Aspen Security Forum participant must apply for credentials to attend all events listed on the official ASF agenda.

What is your cancellation policy?

Written cancellation requests are required. Requests submitted before Tuesday, July 1 will be credited an 80% refund. No refund requests will be accepted after July 1.

Substitutions are permitted with advance notice. Please contact Morgan Walsh (Morgan.Walsh@aspeninstitute.org) for any questions, or to request a refund or substitution.

Travel and Lodging

What is the closest airport to Aspen?

The closest airport to Aspen is the Aspen/Pitkin County Airport (ASE).

Does registration include hotel and airfare?

No, registration does not include hotel and airfare. Attendees must book their own travel to and from Aspen, as well as their hotel stay throughout the Forum. For information on hotels in Aspen, please consult the [ASF Lodging Guide](#). Please note that there is no lodging available for attendees at the Aspen Meadows Resort during the Aspen Security Forum.

On Campus at the Aspen Institute**Where is the Forum held?**

The Aspen Security Forum is held at the Aspen Meadows Resort at:
845 Meadows Rd
Aspen, CO 81611

Where is the list of confirmed speakers and the most up-to-date agenda?

The most up-to-date version of the agenda can be found [here](#) in July. **Please note that, given the nature of our speakers' and moderators' work and schedules, all panels are subject to change.**

What is the best way to get to campus?

The Aspen Security Forum will provide a complimentary shuttle service for the duration of the conference (July 15-18) on a continuous loop, running to the Aspen Institute campus. Please consult the transportation page of the program for the most up-to-date shuttle times. The town of Aspen also participates in [WE-Cycle](#), a state-of-the-art, fully automated bike system that includes 100 bikes available to rent at 14 stations 24/7. For attendees who wish to walk to the Forum, the Aspen Meadows Resort is a short walk from downtown Aspen.

Will there be parking at the Forum?

No parking is available on campus for attendees during the Forum. We strongly encourage attendees to use the Aspen Security Forum shuttle or cross-town shuttle.

Is there a dress code?

Attire throughout the Forum is what we call "Aspen casual," which means no ties for men, and jackets are not required, though some may wear sport coats. Dress is similarly "smart casual" for women.

Is any food served during the Forum?

Lunch will be served in the Walter Isaacson Center and Google Pavilion. Light refreshments are available periodically throughout the day in the Doerr-Hosier Center. Vegetarian options are always available during the Forum. À-la-carte service is also available at the West End Social in the Walter Isaacson Center.

Is there an X handle and/or hashtag for the Aspen Security Forum?

Yes! Find us on X @AspenSecurity and use the hashtag #AspenSecurity.

Is there an available meeting space for one-on-one meetings?

There are no private meeting spaces available. However, there are public areas throughout campus for side conversations including the Aspen Meadows lobby, terraces of the Doerr-Hosier Building, and the Google Pavilion. These meetings must be independently coordinated, and Aspen Security Forum staff members are unable to provide logistical support.

What is your no-weapons policy?

As part of our commitment to ensure the well-being of our event participants and staff, we have a no-weapons policy for all our locations, events, meetings, and convenings, wherever they occur. This policy is in effect regardless of whether an individual has a concealed weapons permit, or whether the location permits carrying weapons. The only exception is for law enforcement or security the Institute has engaged or allowed at its convenings, but only as part of their official role.

Can I record or take photographs of activities at the Aspen Security Forum? Will my voice or image be used?

Activities at the Aspen Security Forum may be recorded or photographed, and the audio, video, and images created may be displayed, distributed, and/or broadcast online, on television or radio, or in print publications. By attending, you are consenting to the use of your image or voice for these purposes.

Around Aspen**What kind of restaurants are in Aspen?**

Aspen is home to a number of fantastic small restaurants that serve a variety of different types of cuisine. Please visit the Aspen Chamber Resort Association's dining page [here](#) for recommendations. Book your table soon, as restaurants tend to fill up fast during the summer months!

What is the weather like in Aspen?

Temperatures in Aspen range from an average of 78 degrees during the day to 63 degrees at night. The temperature cools significantly in the evening and Aspen is known to get hit with thunderstorms in the afternoon, so please be sure to pack accordingly.

How can I mitigate the effects of altitude sickness?

Aspen is located 7,980 feet above sea level, making altitude sickness a common health concern for visitors. We recommend that travelers drink plenty of water as fluids will help your body adjust. It is also highly recommended that attendees avoid alcohol and caffeine on their first few days in Aspen.

Staying in the Loop**Where can I rewatch an ASF session?**

All sessions are live-streamed and available to view afterward on the Aspen Institute [YouTube channel](#) and the Aspen Security Forum [website](#).

How do I receive Forum updates throughout the year?

Subscribe to The Weekly Leaf, a weekly collection of timely articles authored by ASG members, pieces relevant to Forum topics, updates on upcoming digital discussions, and the book of the week [here](#).

Contact Information

If your question was not answered above, or if you require additional assistance, please contact Maggie Davis.

Maggie Davis

Program Coordinator

Aspen Strategy Group and Aspen Security Forum

maggie.davis@aspeninstitute.org

Thank you and we look forward to seeing you in Aspen!

Aspen Meadows Campus Map

Aspen Campus Map



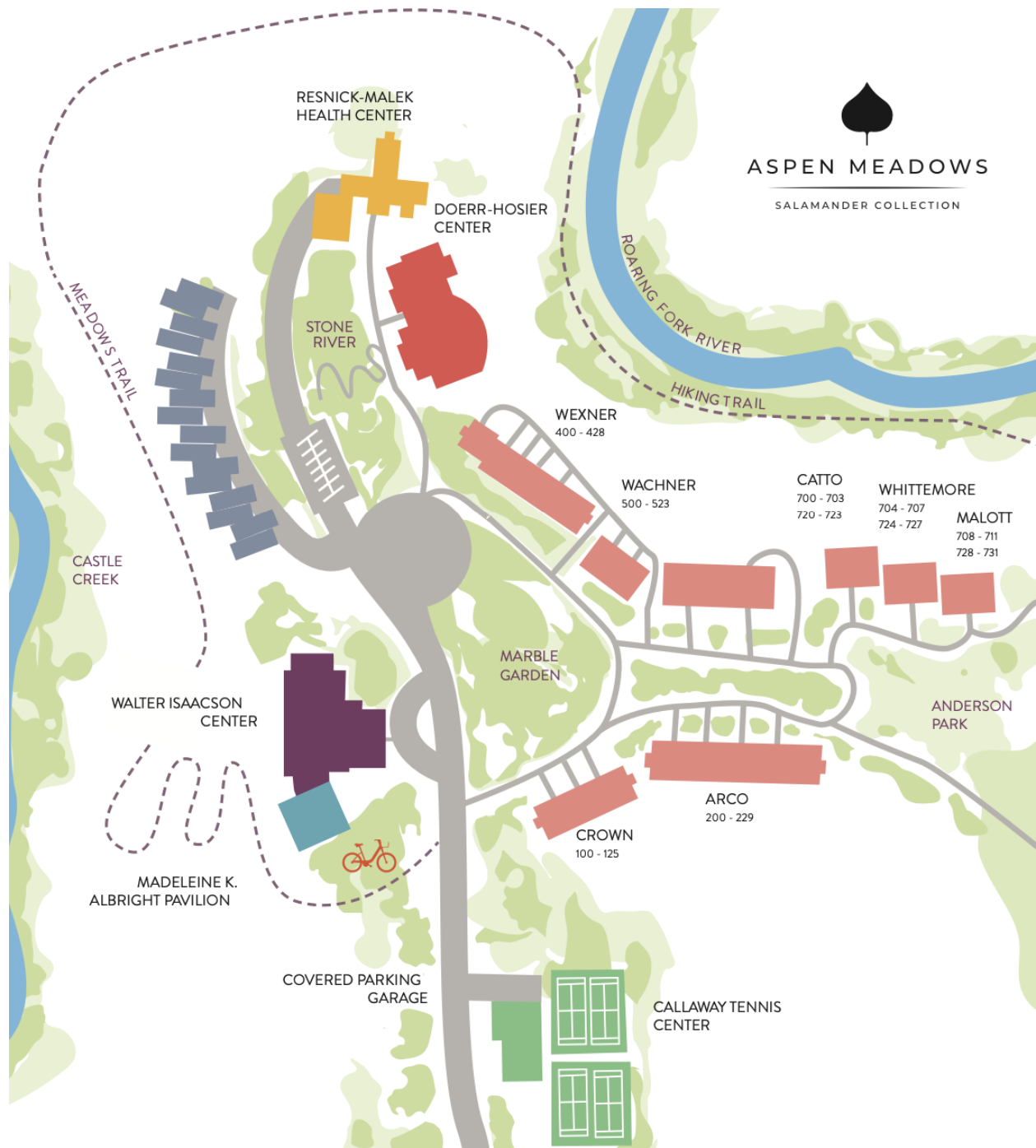

Transportation

Transportation Information

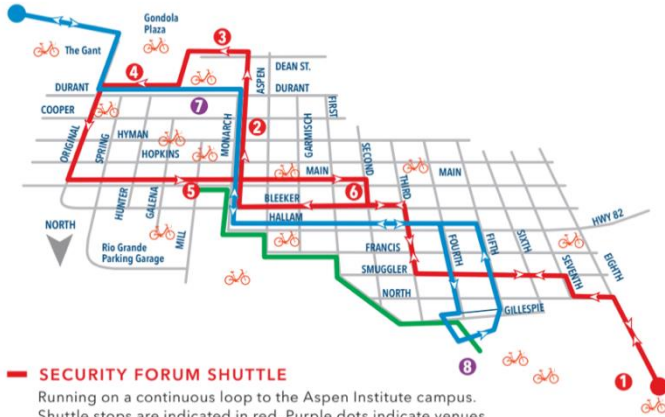

SECURITY FORUM SHUTTLE

Running on a continuous loop to the Aspen Institute campus. Shuttle stops are indicated in red. Purple dots indicate venues and landmarks that are not Security Forum shuttle stops.

TUESDAY, JULY 16

Continuous Service: 12:00 PM - 9:30 PM

WEDNESDAY, JULY 17

Opening Service: 7:00 AM - 9:30 AM

Closing Service: 4:30 PM - 7:00 PM

THURSDAY, JULY 18

Opening Service: 7:00 AM - 9:30 AM

Closing Service: 4:30 PM - 7:00 PM

FRIDAY, JULY 19

Opening Service: 7:00 AM - 9:30 AM

Closing Service: 12:30 PM - 2:30 PM

ASPEN PEDESTRIAN/BIKE WAY SYSTEM

Route to Aspen Institute campus.

FREE CROSS-TOWN SHUTTLE: 970-925-8484

7:45 AM - 10:45 PM DAILY

Every 30 minutes, the RFTA Cross-Town Shuttle provides FREE transportation to and from downtown Aspen to the Aspen Institute campus and Music Tent. The bus stop is in the main Music Tent parking lot.

OUTBOUND From Rubey Park (downtown Aspen) to the Music Tent parking lot at the Aspen Institute campus at :06 and :36 past each hour.

INBOUND From Music Tent parking lot at the Aspen Institute campus to Rubey Park at :15 and :45 past each hour.

- 1 DOERR-HOSIER CENTER/WALTER ISAACSON CENTER 845 Meadows Rd
- 2 LIMELIGHT HOTEL: 355 S Monarch St
- 3 ST. REGIS: 315 E Dean St
- 4 THE LITTLE NELL: 675 E Durant Ave
- 5 HOTEL JEROME: 330 E Main St
- 6 ANNABELLE INN: 232 W Main St
- 7 RUBEY PARK TRANSIT CENTER: 450 E Durant Ave
- 8 MUSIC FESTIVAL PARKING LOT

TRANSPORTATION HOTLINE: 970-544-7913

Please call if you have any questions during the Aspen Security Forum.

HOTEL COURTESY SHUTTLES

ASPEN MEADOWS RESORT

The Meadows offers transportation for Aspen Security Forum guests to and from downtown Aspen, departing from the Walter Isaacson Center on the hour and half hour (starting at 7:00 AM and ending at 10:30 PM). To reserve a space, please call the Meadows Reception Desk at 970-544-7805.

HOTEL JEROME GUEST SHUTTLE 970-429-7736

LIMELIGHT GUEST SHUTTLE 970-925-1028

THE LITTLE NELL GUEST SHUTTLE 970-920-6304

ST. REGIS GUEST SHUTTLE 970-429-9637

For those needing car/van service, please contact your hotel directly as most hotels in Aspen provide these services.

ASPEN HIGH MOUNTAIN TAXI

24-hour service | 970-925-8294

WE-CYCLE STATIONS

Use WE-cycle to get to and from the Forum on your own schedule. It's fun, fast, and free for 30-minute rides. Access Aspen's bikeshare of over 30 stations and 170 bikes, including three stations conveniently located on the Forum campus. Have questions or need more information? Contact WE-cycle ambassadors at (970) 205-9222.

Bear Safety

BearWise Vacation Tips

You are in bear country, so there's a good chance you'll see black bears here, even if you never go into the woods.



Don't Feed the Bears



- Don't leave food, trash or pet food outdoors when no one is around. A few seconds is all it takes for a hungry bear to swipe it.
- Feeding bears or using food to encourage bears to approach you is often illegal and always dangerous.
- Don't throw scraps or leftovers out the car window or into the woods behind your vacation rental.
- If trash container or dumpster is full, don't pile trash outside; take it with you when you leave.

Bear Viewing Guidelines



- Stay in your vehicle; even bears that seem comfortable around people are still wild animals.
- Never approach bears or entice them to approach you.
- Enjoy bears from a safe distance. Stay at least 50 yards or 10 car lengths away.
- Don't block the road to view bears. If permitted, pull over and take photos from the safety of your vehicle.

If you want to see bears, early morning and early evening are good times for viewing and photography.

Driving in Bear Country



- Stay alert, stick to the speed limit and scan the roadsides. If a bear crosses the road, watch for cubs before you drive on.
- Be especially alert at dawn and dusk when bears are most active; black bears are fast and hard to see.
- If you hit a bear, don't try to help it. Call 911 or report to authorities as soon as you can.

Wildlife collisions are not always covered by insurance.



Dogs and bears don't mix. **Keep your dog on a leash at all times when outdoors.** Letting your dog approach or lunge at a bear puts you and your pet in danger.

Discourage Break-Ins



- Lock vehicles; don't leave windows open even a crack. Remove anything with an odor (food, drinks, trash, pet food, scented products).
- Keep exterior doors closed, even when you're there.
- Don't stash food, beverages, trash or recycling on porches/patios/decks.

If You See a Black Bear



- If a bear comes around your place, try to scare it away by making lots of noise yelling or banging pots and pans together from a safe distance.
- If you see a bear near a dumpster or in a building, don't approach or corner it. Give the bear an escape route.

In the Woods

Black bears are seldom aggressive and attacks are rare.

- **Carry bear spray and know how to use it.**
- **If you see a bear before it notices you:** stand still, don't approach and enjoy the moment. Then move away quietly in the opposite direction.
- **If you encounter a bear that is aware of you:** don't run; running may trigger a chase response. Back away slowly in the opposite direction and wait for the bear to leave.

Visit [BearWise.org](https://www.bearwise.org) to learn what to do if a black bear approaches, charges or follows you.

Learn More:
BearWise.org

